

- Lid to riser joint shall be a flexible joint formed using one of the following:
- a. Continuous bead of BM100
 - b. 1/2 Cartridge of Silastic 1080 RTV neutral cure
 - c. 9mm Bostic Butyl Tape

Jointing material to be placed in female portion of joint.

LID JOINT DETAIL
(FLEXIBLE JOINT)

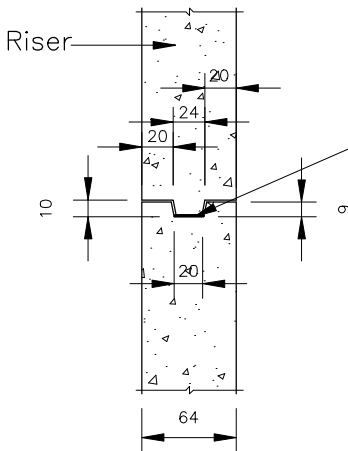

Riser joint to be epoxy glued using Resamax Epoxy Bedding system or approved equivalent

Note:

1. Depth of Epoxy joint shall be 5mm.
2. Jointing material to be placed in female portion of joint.
3. All other details as per D-5 and S-2 Manhole Details.

RISER JOINT DETAIL
(RIGID JOINT)

MANARC

MANUKAU CITY APPROVED
REQUIREMENT

UPDATED:

SEPT 1998

DETAIL No:

MD-12

DETAIL:

HUMES MANHOLE JOINTING SYSTEMS

MANUKAU CITY COUNCIL